

Safety Blow Guns	1-6	A
Ball Valves, Plug Valves	1-6	B
Lockout Valves	1-6	C
Flow Controls & Accessories	1-20	D
Fittings & Hose	1-12	E
Fittings & Tubing	1-70	F
Airline Accessories	1-4	G
Quick Couplings & Adapters	1-16	H
Offer of Sale		

Section H



H

Part Number / Page Index 2
Industrial Interchange Nipples 3-4
Sleevmatic Couplers 5-7
Saflomatic Couplers 8-10
Twist-Lock Quick Connect Couplings 11-13
Economatic Quick Connect Couplings 14-15

Index

Part Number	Page	Part Number	Page	Part Number	Page
16	6	B30-4B	10	H2G-F	3
17	6	B30-5B	10	H2G-J	3
24	6	B30-5BP	10	H3C	3
25	6	B32	9	H3C-E	3
14K	7	B32A	9	H3E	3
14K	10	B32E	9	H3E-F	3
14KY	7	B33	9	H3F	3
14KY	10	B33A	9	H3F-G	3
16-5B	7	B33E	9	H3G	3
16-5BP	7	B34	9	H3G-F	3
16-6B	7	B34-5B	10	H3G-J	3
16-6BP	7	B34-5BP	10	H4EP	4
16-7B	7	B34-6B	10	H4F	4
16E	6	B34C	9	H4FP	4
16G	6	B34F	9	H5E	4
16K	7	B35	9	H5EP	4
16K	10	B35C	9	H5F	4
16KY	7	B35F	9	H5F-G	4
16KY	10	B36	9	H5FP	4
17E	6	B36-6B	10	H5G	4
17G	6	B36-6BP	10	H5G-F	4
21K	7	B36-7B	10	H5G-J	4
21K2	10	B36E	9	H6E	4
21KY	7	B36G	9	H6EP	4
21KY	10	B37	9	H8C	4
24-5B	7	B37E	9	H8C-C3	4
24-5BP	7	B37G	9	H8C-C5	4
24-6B	7	B38	9	H8C-C6	4
24C	6	B38-6B	10	H8C-D	4
24F	6	B38-7B	10	H8CP	4
25C	6	B38-8B	10	H9C	4
25F	6	B38F	9	H9CP	4
38K	10	B38J	9	TL-251-4FP	12
38KY	10	B39	9	TL-251-4MP	12
A2C	15	B39F	9	TL-251-6MP	12
A2C E	15	B39J	9	TL-254-2FP	12
A3C	15	B50-3BP	14	TL-254-2MP	12
A3C E	15	B50-5BP	14	TL-254-4FP	12
A8C	15	B52	14	TL-254-4HB	12
A8CP	15	B52E	14	TL-254-4MP	12
B20-3B	7	B53	14	TL-254-6HB	12
B20-3BP	7	B53E	14	TL-501-12FP	13
B20-4B	7	H00E	3	TL-501-4FP	13
B20-5B	7	H0C	3	TL-501-6FP	13
B20-5BP	7	H0E	3	TL-501-6MP	13
B22	6	H0F	3	TL-501-8FP	13
B22A	6	H1C	3	TL-501-8MP	13
B22-C3	6	H1E	3	TL-504-12MP	13
B22-C5	6	H1F	3	TL-504-4FP	13
B22-C6	6	H2C	3	TL-504-4HB	13
B22E	6	H2C-E	3	TL-504-4MP	13
B23	6	H2E	3	TL-504-6FP	13
B23A	6	H2E-F	3	TL-504-6HB	13
B23E	6	H2F	3	TL-504-6MP	13
B30-3B	10	H2F-G	3	TL-504-8HB	13
B30-3BP	10	H2G	3	TL-504-8MP	13

Industrial interchange nipples conform to MIL-C4109 and are for use with either SleeveMatic or Saflomatic couplers. The industrial interchange nipples are completely interchangeable with similar nipples manufactured by other quick coupling manufacturers conforming to MIL-C4109 requirements.

Hardened wear points and solid barstock construction provide long service life. Precision machined surfaces and hardened load-bearing areas resist the effects of mechanical shock in the most rugged applications.

Female Pipe Thread

Body Size (Inches)	Part No. Steel	Thread Size	Overall Length D	Exposed Length* E	Hex Size F	Largest Diameter G
1/4	H1C	1/8-27	1.38	0.61	0.50	0.58
1/4	H3C	1/4-18	1.56	0.80	0.63	0.72
1/4	H3C-E	3/8-18	1.59	0.83	0.81	0.94
3/8	H1E	1/4-18	1.56	0.65	0.63	0.72
3/8	H3E	3/8-18	1.69	0.74	0.81	0.94
3/8	H3E-F	1/2-14	1.84	0.90	1.00	1.16
1/2	H1F	3/8-18	2.03	0.79	0.81	0.94
1/2	H3F	1/2-14	2.25	1.01	1.00	1.16
1/2	H3F-G	3/4-14	2.38	1.13	1.25	1.44
3/4	H3G-F	1/2-14	2.22	1.06	1.00	1.16
3/4	H3G	3/4-14	2.22	1.06	1.31	1.52
3/4	H3G-J	1-11½	2.41	1.25	1.56	1.80

* This dimension represents portion of nipple that is exposed when nipple is inserted in the coupler.

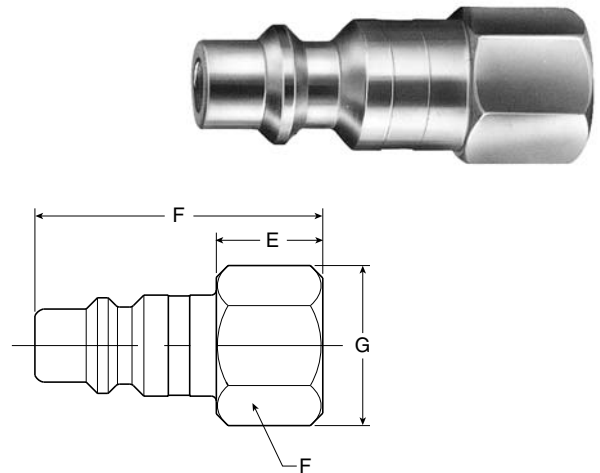

Male Pipe Thread

Body Size (Inches)	Part No. Steel	Thread Size	Overall Length D	Exposed Length* E	Hex Size F	Largest Diameter G
1/4	H0C	1/8-27	1.56	0.80	0.50	0.58
1/4	H2C	1/4-18	1.72	0.95	0.56	0.65
1/4	H2C-E	3/8-18	1.81	1.05	0.69	0.79
3/8	H00E	1/8-27	1.72	0.77	0.63	0.72
3/8	H0E	1/4-18	1.88	0.93	0.63	0.72
3/8	H2E	3/8-18	1.91	0.96	0.69	0.80
3/8	H2E-F	1/2-14	2.13	1.18	0.88	1.01
1/2	H0F	3/8-18	2.31	1.07	0.69	0.79
1/2	H2F	1/2-14	2.47	1.22	0.88	1.01
1/2	H2F-G	3/4-14	2.53	1.29	1.13	1.30
3/4	H2G-F	1/2-14	2.32	1.16	1.00	1.16
3/4	H2G	3/4-14	2.38	1.22	1.06	1.22
3/4	H2G-J	1-11½	2.56	1.40	1.31	1.52

* This dimension represents portion of nipple that is exposed when nipple is inserted in the coupler.

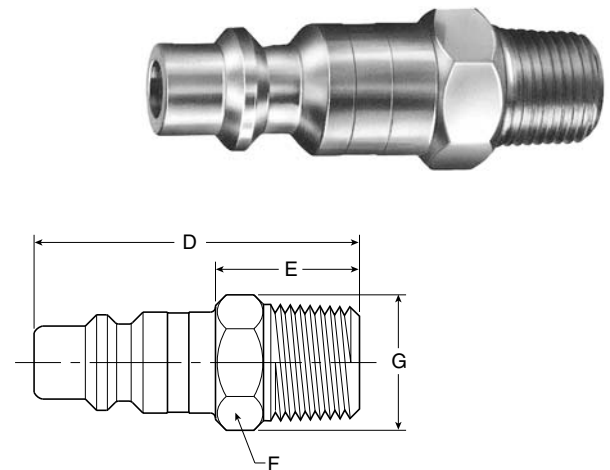

Standard Hose Barb

Body Size (Inches)	Part No. Steel	Hose I.D.	Overall Length D	Exposed Length* E	Largest Diameter G
1/4	H8C	1/4	2.09	1.33	0.55
1/4	H8C-D	5/16	2.09	1.33	0.55
1/4	H9C	3/8	2.09	1.33	.055
3/8	H5E	3/8	2.19	1.24	0.63
3/8	H6E	1/2	2.47	1.52	0.81
1/2	H4F	3/8	2.53	1.29	0.69
1/2	H5F	1/2	2.81	1.57	0.81
1/2	H5F-G	3/4	3.16	1.91	0.94
3/4	H5G-F	1/2	2.75	1.59	0.94
3/4	H5G	3/4	3.44	2.28	1.06
3/4	H5G-J	1	3.44	2.28	1.31

* This dimension represents portion of nipple that is exposed when nipple is inserted in coupler.

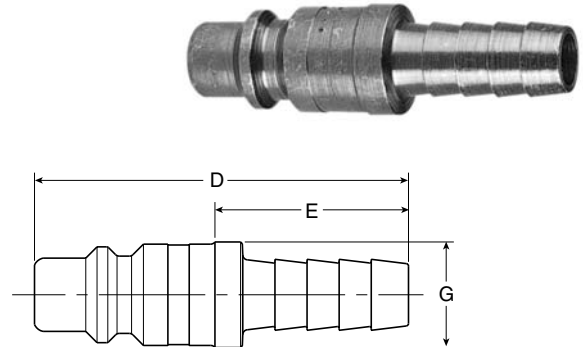

Push-Lok Hose Barb**

Body Size (Inches)	Part No. Steel	Hose I.D.	Overall Length D	Exposed Length* E	Largest Diameter G
1/4	H8CP	1/4	1.93	1.16	0.69
1/4	H9CP	3/8	2.08	1.31	0.86
3/8	H4EP	1/4	2.02	1.08	0.69
3/8	H5EP	3/8	2.17	1.23	0.88
3/8	H6EP	1/2	2.31	1.37	0.97
1/2	H4FP	3/8	2.52	1.27	0.88
1/2	H5FP	1/2	2.66	1.42	0.97

* This dimension represents portion of nipple that is exposed when nipple is inserted in coupler.

** Push-Lok hose barbs are designed for use with a push-lok hose and do not require clamps.

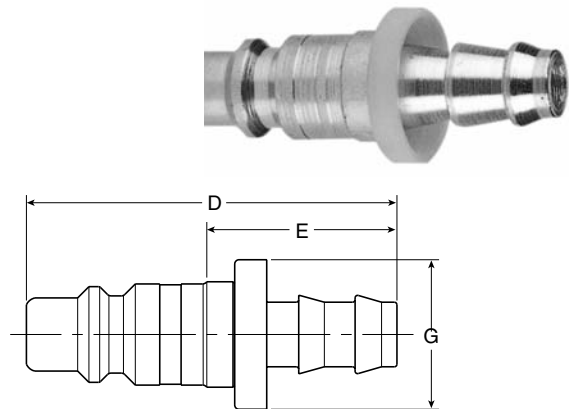

Reusable Hose Fittings

Body Size (Inches)	Part No. Steel	Hose I.D.	O.D.	Overall Length D	Exposed Length* E	Hex Size F	Largest Diameter G
1/4	H8C-C3	1/4	1/2	2.19	1.42	0.69	0.79
1/4	H8C-C5	1/4	9/16	2.19	1.42	0.75	0.87
1/4	H8C-C6	1/4	5/8	2.19	1.42	0.81	0.94

* This dimension represents portion of nipple that is exposed when nipple is inserted in coupler.

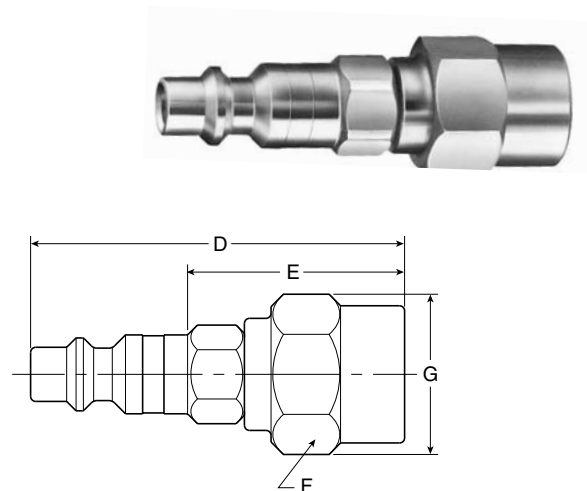

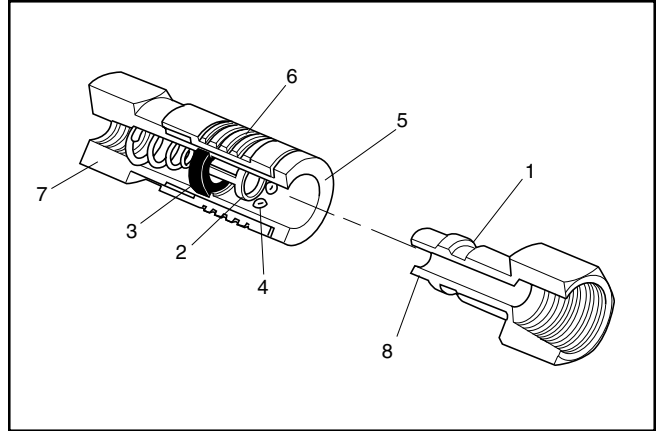
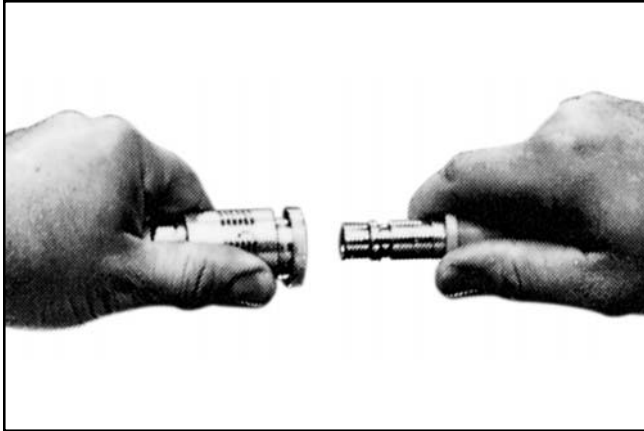

Operation

Sleeve type couplings are widely used to connect air and low-pressure fluid hose lines.

Their compact and economical design uses a ball locking mechanism consisting of captive steel balls that engage the locking groove on the mating nipple. As pictured, the sliding spring loaded sleeve on the coupler must be manually retracted in order to connect or disconnect the nipple. It is easy to do, but two hands are normally required.

Common applications include compressed air, water, grease, paint, limited vacuum and limited gases.

Features

1. Hardened wear points and solid barstock construction provide long life for these quality couplings. Precision machined surfaces resist the effects of mechanical shocks, even in rugged use.
2. Tubular valve with large flow passages delivers high air flows with minimal pressure drop for efficient performance.
3. Molded seals with high quality valve seats form a bubble tight seal for reliable sealing within rated

- working pressures. The tubular valve minimizes wear on the seal and prolongs seal life.
4. Ball locking mechanism with large numbers of steel or stainless steel locking balls improves resistance to wear, insures positive connections and provides accurate alignment. The ball locking also allows swiveling action that reduces hose torque.
5. Sleeve guard resists accidental disconnection by allowing the coupling to ride over obstructions without the sleeve being accidentally retracted. It also contributes to greater strength.
6. Knurling and grooves on sleeve provide gripping surfaces for ease of operation.
7. Wide range of sizes, materials and end terminations are available. Sleeve type quick couplings are offered with male pipe, female pipe, push-lok host barb, standard hose barb and reusable hose fitting ends. Materials offered are Buna N and Fluorocarbon for seals and brass or steel for metals.
8. Interchangeability. Sleevmatic couplers are used with industrial interchange nipples conforming to MIL-C4109.



Specifications

	Body Size		
	1/4	3/8	1/2
Rated Pressure (psi)	300	300	300
Temperature Range			
Buna N (Nitrile)	-40°F to 250°F		
Fluorocarbon	-20°F to 400°F		
Locking Device	4 balls	4 balls	8 balls
Force required to connect (lbs)			
With 80 psi initial pressure	15	28	54
With 100 psi initial pressure	17	29	59
Vacuum data (inches Hg)*			
Disconnected (couplet only)	Not recommended		
Connected	27.4	27.4	27.4

Performance

Sleevmatic
1/4", 3/8", 1/2"

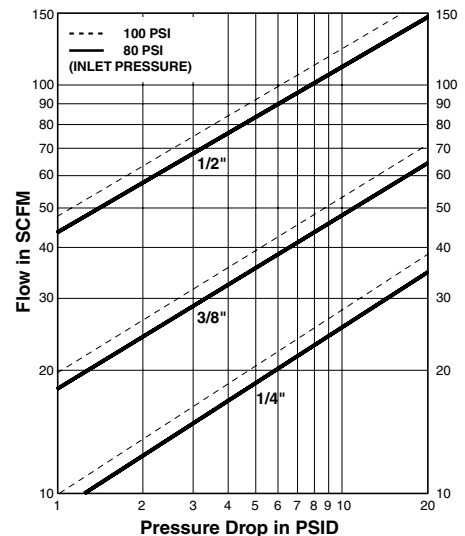

* Couplings for vacuum service should be 100% tested – an extra cost service. Consult factory.

Part Numbers & Dimensions

Slevmatic Couplers

Female Pipe Thread

Body Size (Inches)	Part No.		Thread Size	Overall Length A	Hex Size B	Largest Diameter C
	Brass	Steel				
1/4	B23A	—	1/8-27	1.83	0.75	0.88
1/4	B23	—	1/4-18	1.83	0.75	0.88
1/4	B23E	—	3/8-18	1.89	0.81	0.88
3/8	—	25C	1/4-18	2.22	0.88	1.06
3/8	—	25	3/8-18	2.28	0.88	1.06
3/8	—	25F	1/2-14	2.55	1.00	1.16
1/2	—	17E	3/8-18	2.74	1.00	1.19
1/2	—	17	1/2-14	2.96	1.00	1.19
1/2	—	17G	3/4-14	3.19	1.25	1.44

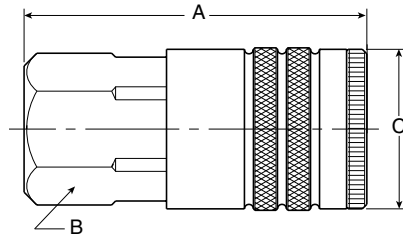

Male Pipe Thread

Body Size (Inches)	Part No.		Thread Size	Overall Length A	Hex Size B	Largest Diameter C
	Brass	Steel				
1/4	B22A	—	1/8-27	1.89	0.75	0.88
1/4	B22	—	1/4-18	2.05	0.75	0.88
1/4	B22E	—	3/8-18	2.08	0.75	0.88
3/8	—	24C	1/4-18	2.36	0.88	1.06
3/8	—	24	3/8-18	2.39	0.88	1.06
3/8	—	24F	1/2-14	2.55	0.88	1.06
1/2	—	16E	3/8-18	2.93	1.00	1.19
1/2	—	16	1/2-14	3.08	1.00	1.19
1/2	—	16G	3/4-14	3.21	1.13	1.30

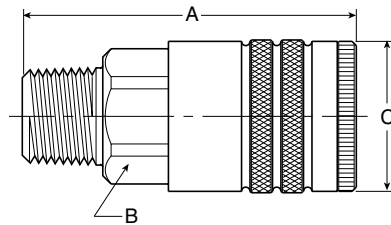

Reusable Hose Fitting

Body Size (Inches)	Part No.	Hose		Overall Length A	Hex Size B	Largest Diameter C
		brass	ID. O.D.			
1/4	B22-C3	1/4	1/2	2.45	0.75	0.88
1/4	B22-C5	1/4	9/16	2.45	0.75	0.88
1/4	B22-C6	1/4	5/8	2.45	0.75	0.94

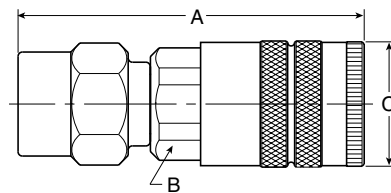

NOTE: To indicate Fluorocarbon seals, add the letter Y as a suffix to the catalog number of the coupler.
Example: B23AY

Part Numbers & Dimensions

Slevmatic Couplers

Standard Hose Barb

Body Size (Inches)	Part No.		Hose I.D.	Overall Length A	Hex Size B	Largest Diameter C
	Brass	Steel				
1/4	B20-3B	—	1/4	2.49	0.75	0.88
1/4	B20-4B	—	5/16	2.49	0.75	0.88
1/4	B20-5B	—	3/8	2.49	0.75	0.88
3/8	—	24-5B	3/8	2.86	0.88	1.06
3/8	—	24-6B	1/2	3.08	0.88	1.06
1/2	—	16-5B	3/8	3.37	1.00	1.19
1/2	—	16-6B	1/2	3.62	1.00	1.19
1/2	—	16-7B	3/4	3.96	1.00	1.19

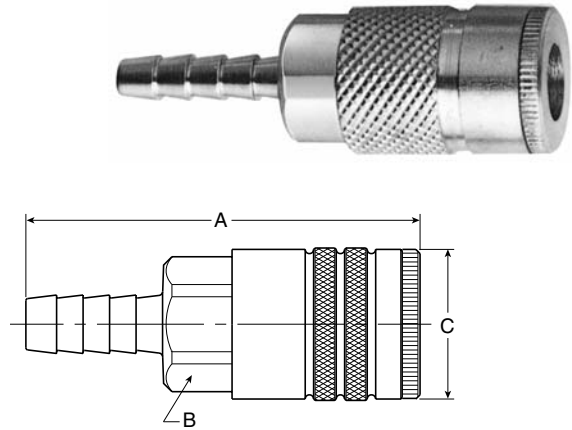

Push-Lok Hose Barb*

Body Size (Inches)	Part No.		Hose I.D.	Overall Length A	Hex Size B	Largest Diameter C
	Brass	Steel				
1/4	B20-3BP	—	1/4	2.32	0.75	0.88
1/4	B20-5BP	—	3/8	2.47	0.75	0.88
3/8	—	24-5BP	3/8	2.88	0.88	1.06
1/2	—	16-5BP	3/8	3.35	1.00	1.19
1/2	—	16-6BP	1/2	3.46	1.00	1.19

* Push-Lok hose barbs are designed for use with push-lok hose and do not require clamps.

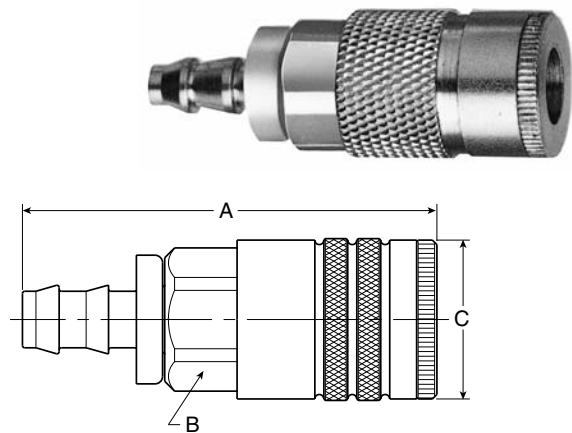

NOTE: To indicate Fluorocarbon seals, add the letter Y as a suffix to the catalog number of the coupler.
Example: B20 3BY

Repair Kits

Body Size	Buna N (Nitrile)	Fluorocarbon
1/4	21K	21KY
3/8	14K	14KY
1/2	16K	16KY

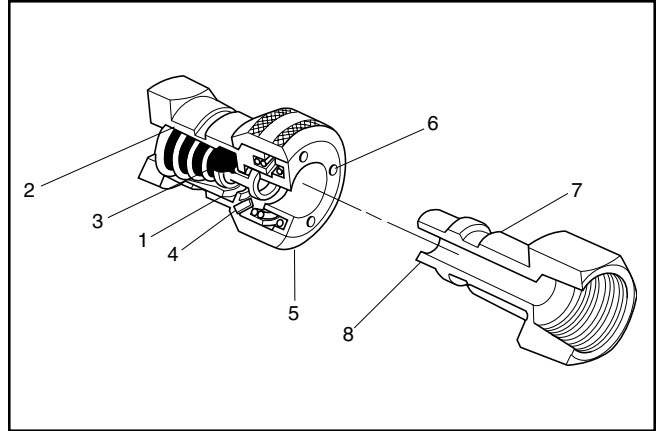
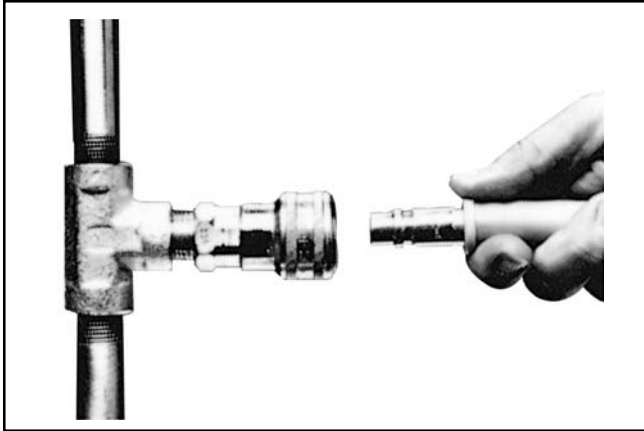

Operation

Push type couplings feature one-handed “automatic” connection by pushing the nipple into the coupler – provided the coupler half is firmly mounted.

The locking mechanism of Safromatic push type couplers consists of pawls or pins which act directly on the sleeve, thereby causing the sleeve to automatically retract when the mating nipple is inserted. The sleeve must be manually retracted in order to remove the nipple.

Safromatic couplings are push type “single shut off” couplings.

Common applications include compressed air, water, grease, paint, limited vacuum and limited gas.

Features

1. Safromatic tubular valves with their large flow windows deliver high air flow with minimum pressure drop – for efficient performance of air tools and other actuators. The tubular valve also provides 360 degree seal support to prevent cold flow and bore constriction, thereby extending seal life.

2. Tapered flow recesses in the valve body provide maximum flow capability.
3. Precision molded seals with high quality valve seats for a bubble tight seal that assures reliable sealing within rated working pressures. The Safromatic design with its 360° seal support gives maximum seal retention.
4. Locking pawls are of hardened stainless steel for a durable locking mechanism that provides good alignment and sideload resistance.
5. Push-to-connect design permits one-handed connection when the coupler half is rigidly mounted.
6. Back pressure vent holes allow easier connections especially with liquids.
7. Hardened wear points and solid barstock construction provide long life for these quality couplings. Precision machined surfaces resist the effects of mechanical shocks, even in rugged use.
8. Interchangeability. Safromatic couplers are used with industrial interchange nipples conforming to MIL-C4109.

Specifications

	Body Size			
	1/4	3/8	1/2	3/4
Rated Pressure (psi)	300	300	300	300
Temperature Range				
Buna N (Nitrile)	-40°F to 250°F			
Fluorocarbon	-20°F to 400°F			
Locking Device	3 pawls	4 pawls	5 pawls	6 pawls
Force required to connect (lbs)				
With 80 psi initial pressure	24	41	63	83
With 100 psi initial pressure	26	44	69	95
Vacuum Data (inches Hg)*				
Disconnected (coupler only)	Not recommended			
Connected	27.4	27.4	27.4	27.4

*Couplings for vacuum service should be 100% tested – an extra cost service. Consult factory.

Performance

Safromatic
1/4" to 3/4"

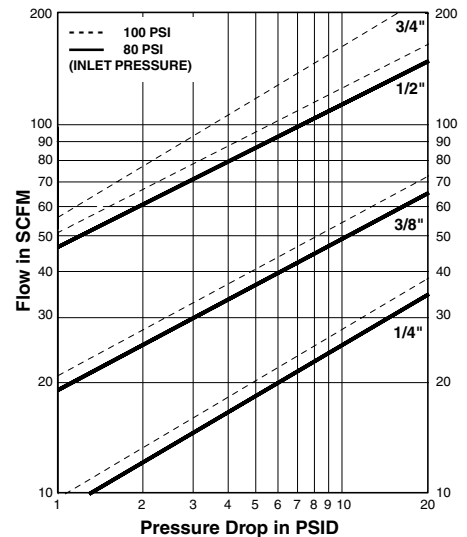

Female Pipe Thread

Body Size (Inches)	Part No. Brass	Thread Size	Overall Length A	Hex Size B	Largest Diameter C
1/4	B33A	1/8-27	1.96	0.75	1.20
1/4	B33	1/4-18	1.96	0.75	1.20
1/4	B33E	3/8-18	2.03	0.81	1.20
3/8	B35C	1/4-18	2.26	0.88	1.39
3/8	B35	3/8-18	2.33	0.88	1.39
3/8	B35F	1/2-14	2.60	0.88	1.39
1/2	B37E	3/8-18	2.75	1.00	1.52
1/2	B37	1/2-14	2.97	1.00	1.52
1/2	B37G	3/4-14	3.21	1.25	1.52
3/4	B39F	1/2-14	2.86	1.31	1.90
3/4	B39	3/4-14	3.00	1.31	1.90
3/4	B39J	1-11½	3.19	1.56	1.90

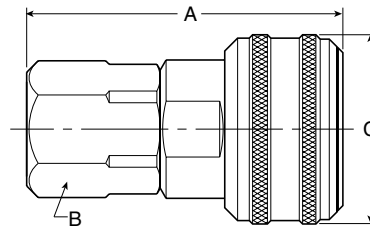

Male Pipe Thread

Body Size (Inches)	Part No. Brass	Thread Size	Overall Length A	Hex Size B	Largest Diameter C
1/4	B32A	1/8-27	2.03	0.75	1.20
1/4	B32	1/4-18	2.18	0.75	1.20
1/4	B32E	3/8-18	2.18	0.75	1.20
3/8	B34C	1/4-18	2.38	0.88	1.39
3/8	B34	3/8-18	2.44	0.88	1.39
3/8	B34F	1/2-14	2.57	0.88	1.39
1/2	B36E	3/8-18	2.92	1.00	1.52
1/2	B36	1/2-14	3.09	1.00	1.52
1/2	B36G	3/4-14	3.12	1.13	1.52
3/4	B38F	1/2-14	2.93	1.31	1.90
3/4	B38	3/4-14	2.95	1.31	1.90
3/4	B38J	1-11½	3.12	1.31	1.90

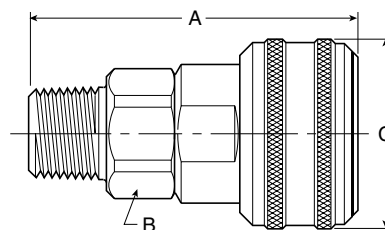

NOTE: To indicate Fluorocarbon seals, add the letter Y as a suffix to the catalog number of the coupler.
 Example: B33AY

Standard Hose Barb

Body Size (Inches)	Part No. Brass	Hose I.D.	Overall Length A	Hex Size B	Largest Diameter C
1/4	B30-3B	1/4	2.62	0.75	1.20
1/4	B30-4B	5/16	2.62	0.75	1.20
1/4	B30-5B	3/8	2.62	0.75	1.20
3/8	B34-5B	3/8	2.85	0.88	1.39
3/8	B34-6B	1/2	2.85	0.88	1.39
1/2	B36-6B	1/2	3.33	1.00	1.52
1/2	B36-7B	3/4	3.86	1.00	1.52
3/4	B38-6B	1/2	3.16	1.31	1.90
3/4	B38-7B	3/4	3.69	1.31	1.90
3/4	B38-8B	1	3.93	1.31	1.90

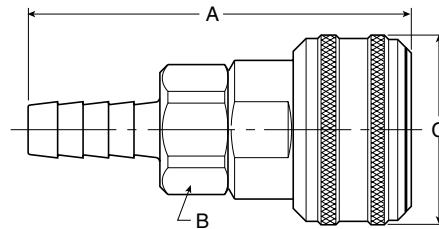

Push-Lok Hose Barb*

Body Size (Inches)	Part No. Brass	Hose I.D.	Overall Length A	Hex Size B	Largest Diameter C
1/4	B30-3BP	1/4	2.45	0.75	1.20
1/4	B30-5BP	3/8	2.60	0.75	1.20
3/8	B34-5BP	3/8	2.82	0.88	1.39
1/2	B36-6BP	1/2	3.46	1.00	1.52

* Push-Lok hose barbs are designed for use with push-lok hose and do not require clamps.

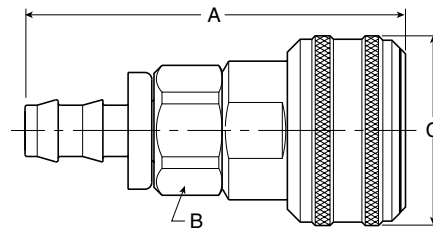

NOTE: To indicate Fluorocarbon seals, add the letter Y as a suffix to the catalog number of the coupler.
 Example: B30 3BY

Repair Kits

Body Size	Buna N (Nitrile)	Fluorocarbon
1/4	21K2	21KY
3/8	14K	14KY
1/2	16K	16KY
3/4	38K	38KY

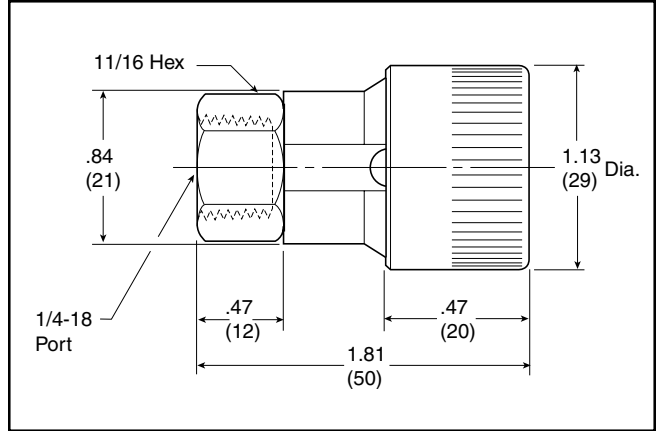

Operation

To lock – plug in. To unlock – give the check unit sleeve a 1/8 turn.

Plug in for compressed air – when you need it – where you need it. Make it as accessible to your needs as electricity. Install check units around your shop at strategic locations – on walls, work benches, columns, etc. Equip your pneumatic tools, etc. with mating adapters and simply plug into the check unit. Acts exactly like electric sockets and plugs. Permits use of shorter, more manageable lengths of hose. Designed for compressed air use. Consult your distributor for other fluids.

Features

- Engineered for speedy coupling and uncoupling. Plug in to lock . . . twist to unlock.
- Adapter swivels to prevent hose kinks.
- Designed to protect against accidental uncoupling.
- A wide variety of types and sizes available.

Application

Standard Twist-Lock couplings are ideal for low to medium air flows, such as air tools. Heavy-duty Twist-Lock couplings are designed for greater flow capacities.



Specifications

Body: Zinc

Sleeve and adapter: Zinc plated

Seals: Buna N

Working pressure: Up to 250 PSIG

Temperature:

Standard: -10°F to 165°F

High temperature option: -10°F to 400°F

Flow Chart

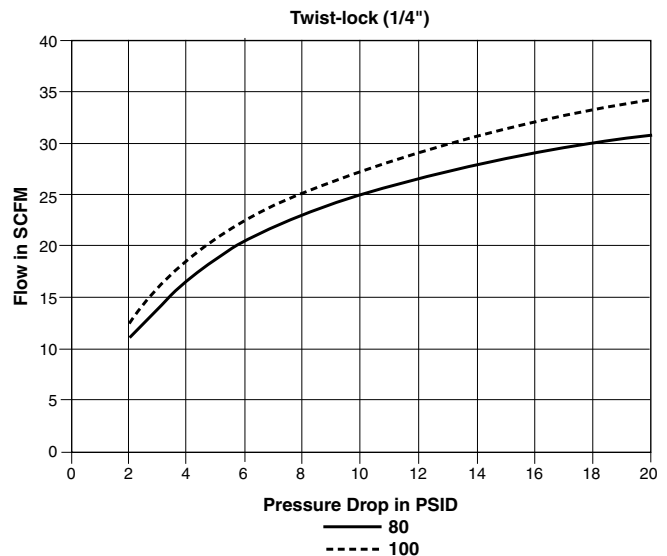

Standard

Check Unit – Female Thread

Part Number	Inlet Port	Overall Length	Maximum Diameter
TL-251-4FP	1/4"	1.875"	1.125"



Check Unit – Male Thread

Part Number	Inlet Pipe Thread	Overall Length	Maximum Diameter
TL-251-4MP	1/4"	2.125"	1.125"
TL-251-6MP	3/8"	2.125"	1.125"



Adapter – Male Thread

Part Number	Pipe Thread
TL-254-2MP	1/8"
TL-254-4MP	1/4"



Adapter – Female Thread

Part Number	Port
TL-254-2FP	1/8"
TL-254-4FP	1/4"



Adapter – Serrated Shank

Part Number	For Hose I.D.
TL-254-4HB	1/4"
TL-254-6HB	3/8"



Standard Check Unit Repair Kit – 21K

Part Numbers & Dimensions

Heavy Duty

Check Unit – Female Thread

Part Number	Inlet Port	Overall Length	Maximum Diameter
TL-501-4FP	1/4	2.188	1.50"
TL-501-6FP	3/8	2.188	1.50"
TL-501-8FP	1/2	2.500	1.50"
TL-501-12FP	3/4	2.562	1.50"



Check Unit – Male Thread

Part Number	Inlet Port	Overall Length	Maximum Diameter
TL-501-6MP	3/8	2.312"	1.50"
TL-501-8MP	1/2	2.750"	1.50"



Adapter – Male Thread

Part Number	Pipe Thread
TL-504-4MP	1/4"
TL-504-6MP	3/8"
TL-504-8MP	1/2"
TL-504-12MP	3/4"



Adapter – Female Thread

Part Number	Pipe Thread
TL-504-4FP	1/4"
TL-504-6FP	3/8"



Adapter – Serrated Shank

Part Number	For Hose I.D.
TL-504-4HB	1/4"
TL-504-6HB	3/8"
TL-504-8HB	1/2"



Heavy Duty Check Unit Repair Kit – 16K

Description

Economat couplings feature the tubular valve in a coupler body that interchanges with ARO 210 and similar design couplers and nipples. Economat couplings are available only in 1/4" body size, but include 3/8" thread size. Economat couplings have brass bodies with steel sleeves and valves for durability. Standard seal material is Buna N (Nitrile).

Specifications

Body size: 1/4"

Rated Pressure: 300 psi

Temperature Range (standard seals): -40°F to 250°F

Locking Device: 4 balls

Couplers

Female Pipe Thread

Body Size (Inches)	Part No. Brass	Thread Size	Overall Length A	Hex Size B	Largest Diameter C
1/4	B53	1/4-18	1.86	0.75	0.88
1/4	B53E	3/8-18	1.92	0.81	0.88

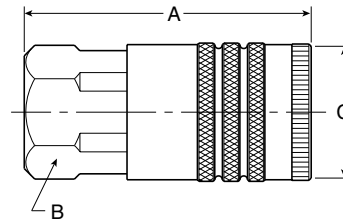
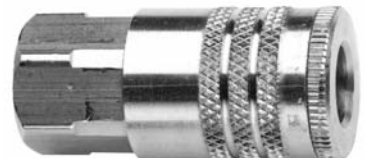

Male Pipe Thread

Body Size (Inches)	Part No. Brass	Thread Size	Overall Length A	Hex Size B	Largest Diameter C
1/4	B52	1/4-18	2.08	0.75	0.88
1/4	B52E	3/8-18	2.11	0.75	0.88

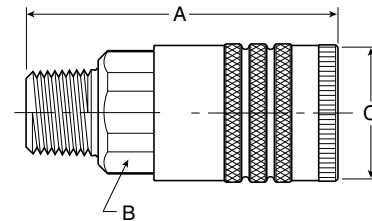

Push-Lok Hose Barb*

Body Size (Inches)	Part No. Brass	Hose I.D.	Overall Length A	Hex Size B	Largest Diameter C
1/4	B50-3BP	1/4	2.35	0.75	0.88
1/4	B50-5BP	3/8	2.50	0.75	0.88

* Push-Lok hose barbs are designed for use with push-lok hose and do not require clamps.

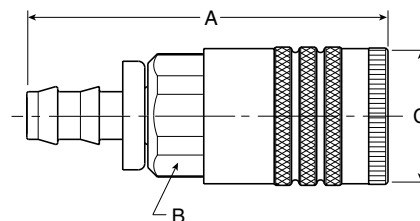

Nipples

Female Pipe Thread

Body Size (Inches)	Part No. Steel	Thread Size	Overall Length D	Exposed Length* E	Hex Size F	Largest Diameter G
1/4	A3C	1/4-18	1.47	0.66	0.63	0.72
1/4	**A3C E	3/8-18	1.50	0.69	0.81	0.94

* This dimension represents portion of nipple that is exposed when nipple is inserted in coupler.

** Semi-standard. Consult factory for price and delivery.

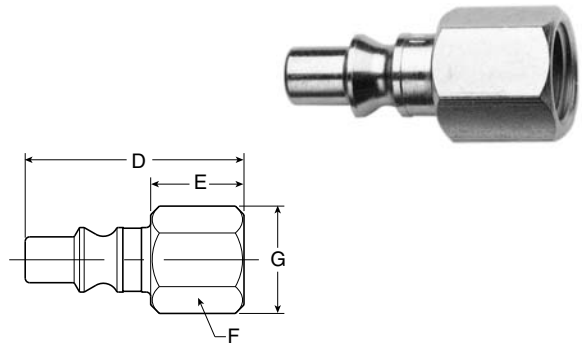

Male Pipe Thread

Body Size (Inches)	Part No. Steel	Thread Size	Overall Length D	Exposed Length* E	Hex Size F	Largest Diameter G
1/4	A2C	1/4-18	1.63	0.82	0.56	0.65
1/4	**A2C E	3/8-18	1.72	0.92	0.69	0.79

* This dimension represents portion of nipple that is exposed when nipple is inserted in coupler.

** Semi-standard. Consult factory for price and delivery.

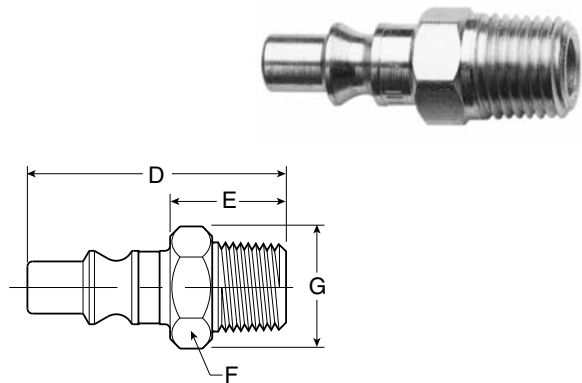

Push-Lok Hose Barb**

Body Size (Inches)	Part No. Steel	Hose I.D.	Overall Length D	Exposed Length* E	Largest Diameter G
1/4	A8CP	1/4	1.83	1.03	0.69

* This dimension represents portion of nipple that is exposed when nipple is inserted in coupler.

** Push-Lok bars are designed for use with push-lok hose and do not require clamps.

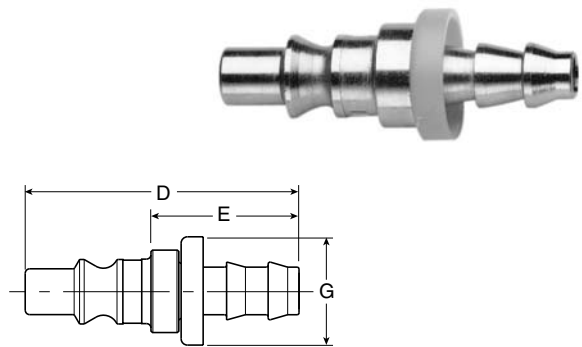

Standard Hose Barb

Body Size (Inches)	Part No. Steel	Hose I.D.	Overall Length D	Exposed Length* E	Largest Diameter G
1/4	A8C	1/4	2.00	1.19	0.56

* This dimension represents portion of nipple that is exposed when nipple is inserted in coupler.

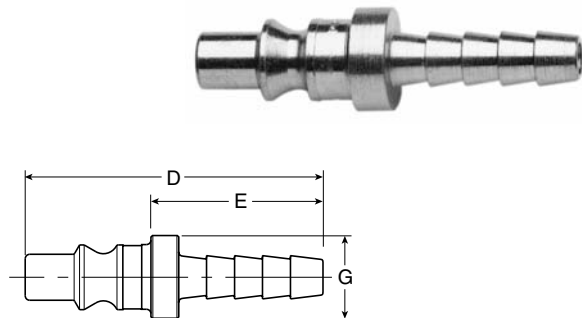

Notes
