

⚠ WARNING
<p>To avoid unpredictable system behavior that can cause personal injury and property damage:</p> <ul style="list-style-type: none"> • Disconnect electrical supply (when necessary) before installation, servicing, or conversion. • Disconnect media source and depressurize all media lines connected to this product before installation, servicing, or conversion. • Operate within the manufacturer's specified pressure, temperature, and other conditions listed in these instructions. • Medium must be moisture-free if ambient temperature is below freezing. • Service according to procedures listed in these instructions. • Installation, service, and conversion of these products must be performed by knowledgeable personnel who understand how pneumatic products are to be applied. • After installation, servicing, or conversion, media and electrical supplies (when necessary) should be connected and the product tested for proper function and leakage. If audible leakage is present, or the product does not operate properly, do not put into use. • Warnings and specifications on the product should not be covered by paint, etc. If masking is not possible, contact your local representative for replacement labels.

Introduction

Follow these instructions when installing, operating, or servicing the product.

Application Limits

These products are intended for use in general purpose compressed media systems only.

Operating Pressure:

	kPa	PSIG	bar
Maximum Inlet Pressure	1034	150	10.3

Ambient Temperature Range: 4°C to 52°C
 (40°F to 125°F)

⚠ WARNING
<p>Product rupture can cause serious injury. Do not connect regulator to bottled gas. Do not exceed maximum primary pressure rating.</p>

Symbols

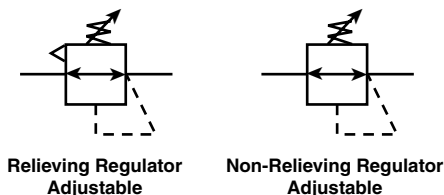

Installation

Before installing, blow out pipe line to remove all foreign matter. This unit has DRYSEAL pipe threads; use pipe compound or tape sparingly to male threads only. Install regulator in pipe line so that water will flow in direction of arrow stamped on body, install as near as possible to equipment serviced.

⚠ CAUTION: DO NOT OVERTIGHTEN FITTINGS.

Reduced Pressure Adjustment

To adjust reduced pressure settings, pull knob out and turn knob clockwise to increase pressure setting and counter-clockwise to lower setting. Push knob in to lock adjustment. For best adjustment, set pressure on the rise by turning knob clockwise. With relieving type regulators (air use only), the reduced pressure follows adjustment of the screw. With non-relieving regulators, adjustment for lower reduced pressure will not be obtained until the reduced pressure system is "bled-off", or until air flow (or water flow) starts.

Maintenance – Cleaning

Note: To clean, it is not necessary to remove regulator from line. Refer to drawing as guide in reassembly. If the supply is kept the regulator should provide long periods of uninterrupted service. Erratic regulator operation or loss of regulation is most always due to dirt in the poppet area. To clean, shut off air line pressure and disassemble the regulator. Refer to drawing as a guide to disassembly and subsequent reassembly. Clean parts with mild soap and water or denatured alcohol and blow out body with compressed air. When reassembling, make sure the seat is firmly in place. For R25, tighten spring cage slightly more than hand tight (60 - 70 inch pounds torque). For R45, tighten spring cage to 150 inch pounds torque.

⚠ WARNING
<p>FAILURE OR IMPROPER SELECTION OR IMPROPER USE OF THE PRODUCTS AND/OR SYSTEMS DESCRIBED HEREIN OR RELATED ITEMS CAN CAUSE DEATH, PERSONAL INJURY AND PROPERTY DAMAGE.</p> <p>This document and other information from The Company, its subsidiaries and authorized distributors provide product and/or system options for further investigation by users having technical expertise. It is important that you analyze all aspects of your application, including consequences of any failure and review the information concerning the product or systems in the current product catalog. Due to the variety of operating conditions and applications for these products or systems, the user, through its own analysis and testing, is solely responsible for making the final selection of the products and systems and assuring that all performance, safety and warning requirements of the application are met.</p> <p>The products described herein, including without limitation, product features, specifications, designs, availability and pricing, are subject to change by The Company and its subsidiaries at any time without notice.</p>

EXTRA COPIES OF THESE INSTRUCTIONS ARE AVAILABLE FOR INCLUSION IN EQUIPMENT / MAINTENANCE MANUALS THAT UTILIZE THESE PRODUCTS. CONTACT YOUR LOCAL REPRESENTATIVE.

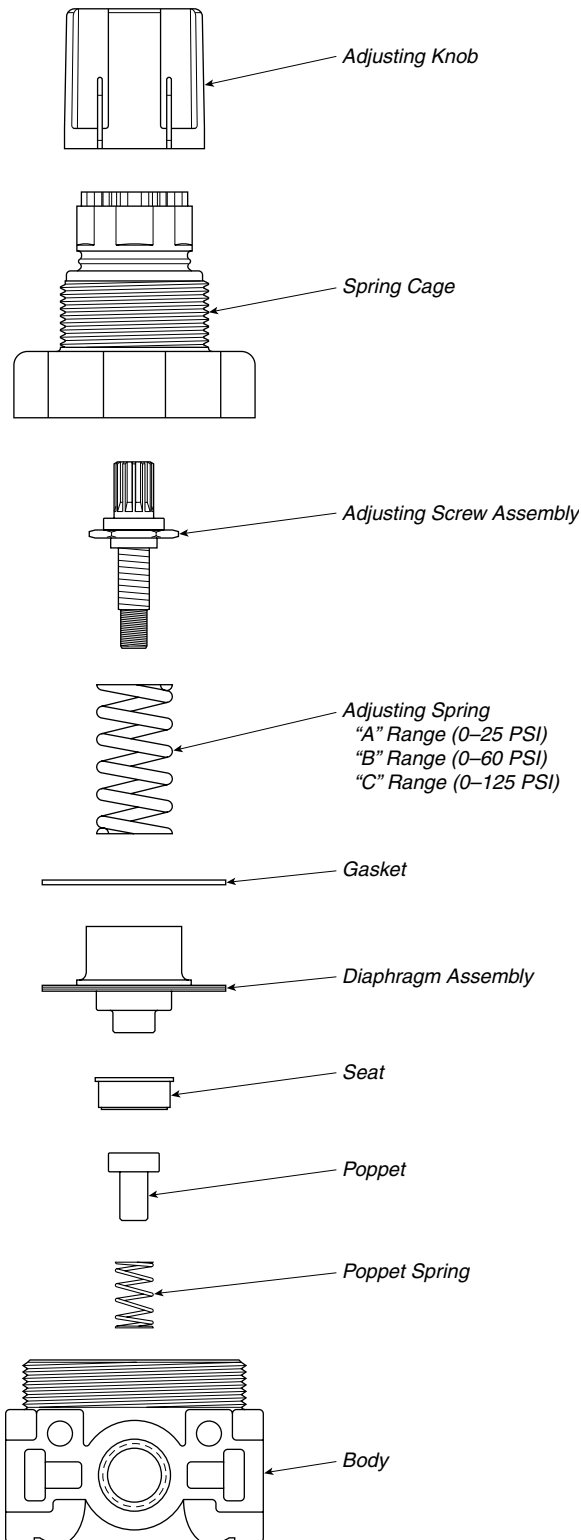

Service Kits / Parts Available

Description	R25	R45
Non-Relieving Repair Kit	RKR25KY	RKR45KY
Relieving Repair Kit	RKR25Y	RKR45Y
Spring Cage Repair Kit	CKR364Y	CKR45Y
Adjusting Knob	R35-0545P	

Accessories

Panel Mount Bracket and Nut	SA161X57
Panel Mount Nut	R05X51

Air Flow Characteristics
R25-02C & R45-03C

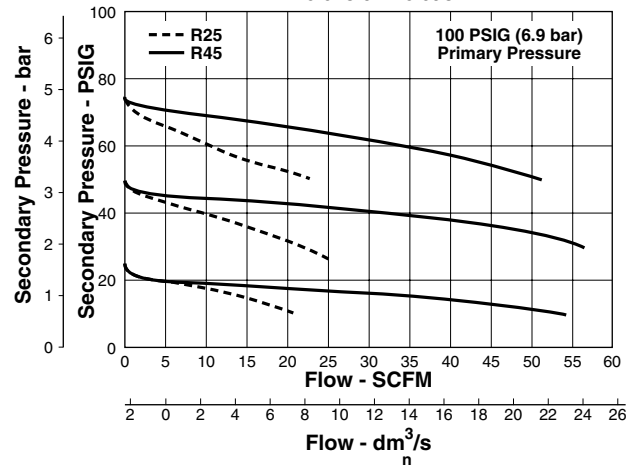

Water Flow Characteristics
R25-02CK & R45-03CK

