

**Installation & Service Instructions:
IS-RKL50G**

Pulse Generator

ISSUED: July, 2004

Supersedes: None

Doc.# ISRKL50G, ECN# 030499, Rev.1

⚠ WARNING

To avoid unpredictable system behavior that can cause personal injury and property damage:

- Disconnect electrical supply (when necessary) before installation, servicing, or conversion.
- Disconnect air supply and depressurize all air lines connected to this product before installation, servicing, or conversion.
- Operate within the manufacturer's specified pressure, temperature, and other conditions listed in these instructions.
- Medium must be moisture-free if ambient temperature is below freezing.
- Service according to procedures listed in these instructions.
- Installation, service, and conversion of these products must be performed by knowledgeable personnel who understand how pneumatic products are to be applied.
- After installation, servicing, or conversion, air and electrical supplies (when necessary) should be connected and the product tested for proper function and leakage. If audible leakage is present, or the product does not operate properly, do not put into use.
- Warnings and specifications on the product should not be covered by paint, etc. If masking is not possible, contact your local representative for replacement labels.

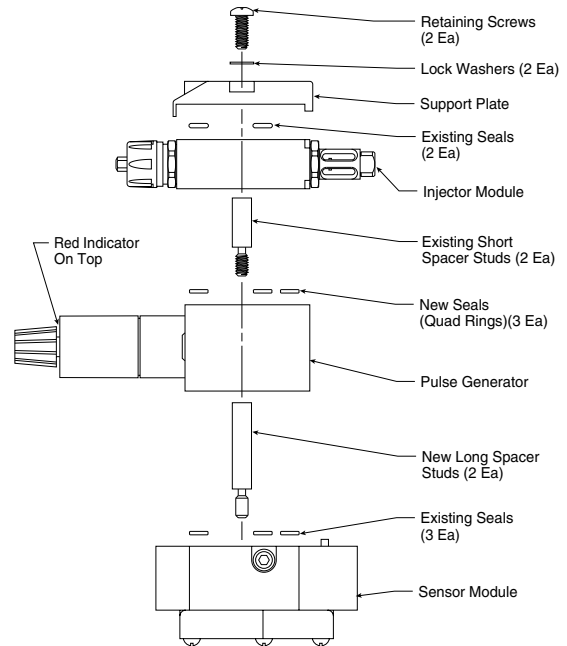

L50

1. Remove Retaining Screws, Support Plate, Injection Module and Short Spacer Studs, (Option is to leave short spacer studs in plate and add long studs to top of short ones).
2. Install long studs then short ones on top.
3. Make sure 3 Quad Rings are in place on Sensor Module and install Pulse Generator.
4. Place 3 Quad Rings on top of Pulse Generator.
5. Reinstall Injection Module, Existing Seals, Support Plate and Screws and torque screws to 35 in./lb.

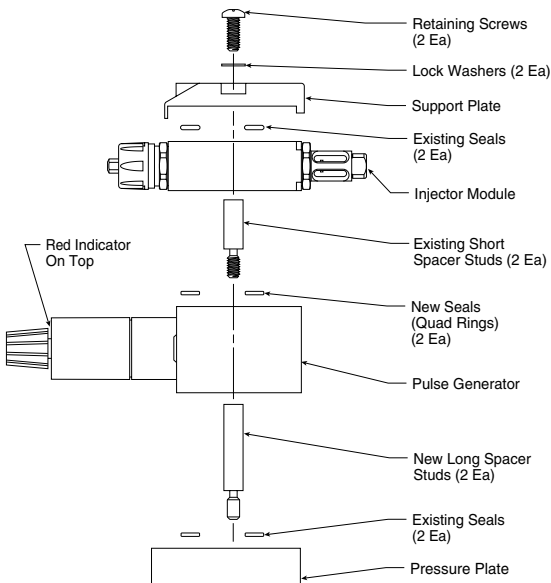

PL50

1. Remove Retaining Screws, Support Plate, Injection Module and Short Spacer Studs, (Option is to leave short spacer studs in plate and add long studs to top of short ones).
2. Install long studs then short ones on top.
3. Make sure 2 Quad Rings are in place on Pressure Plate and install Pulse Generator.
4. Place 2 Quad Rings on top of Pulse Generator.
5. Reinstall Injection Module, Existing Seals, Support Plate and Screws and torque screws to 35 in./lb.

⚠ WARNING

FAILURE OR IMPROPER SELECTION OR IMPROPER USE OF THE PRODUCTS AND/OR SYSTEMS DESCRIBED HEREIN OR RELATED ITEMS CAN CAUSE DEATH, PERSONAL INJURY AND PROPERTY DAMAGE.

This document and other information from The Company, its subsidiaries and authorized distributors provide product and/or system options for further investigation by users having technical expertise. It is important that you analyze all aspects of your application, including consequences of any failure and review the information concerning the product or systems in the current product catalog. Due to the variety of operating conditions and applications for these products or systems, the user, through its own analysis and testing, is solely responsible for making the final selection of the products and systems and assuring that all performance, safety and warning requirements of the application are met.

The products described herein, including without limitation, product features, specifications, designs, availability and pricing, are subject to change by The Company and its subsidiaries at any time without notice.

EXTRA COPIES OF THESE INSTRUCTIONS ARE AVAILABLE FOR INCLUSION IN EQUIPMENT / MAINTENANCE MANUALS THAT UTILIZE THESE PRODUCTS. CONTACT YOUR LOCAL REPRESENTATIVE.